

Polybush®

DIFFERENTIAL MOUNTING KIT

COMFORT BLUE KIT45

Triumph TR5 & TR6

Triumph TR250



Part Number: **RR1552B**

1. Remove existing bushes from the differential
2. Assemble the bush shown in diagram A & B
3. Depending on the mounting pins fitted to the vehicle, the 34J is supplied with 2 different types of the washers. **A standard vehicle with OEM mounting studs will need the smaller ID washers.** Some vehicles may have uprated mounting studs which have larger OD. This setup will require the larger ID of the 2 styles of washer.

NOTE: The unused washer is not required.

4. Mount the bushes to the differential ensuring the flange plate is to the underside of the diff. Loosely fit the bolts.
5. Lift the differential into position and align with the mounting studs.
6. Using the correct washer for your vehicle, place the washer beneath the bush and fit the nut below (C)
7. Torque to the 2 nuts to manufacturers settings
8. Ensure the differential is aligned and the torque the mounting flange bolts to the manufacturers settings.

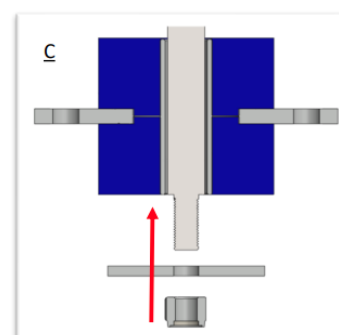
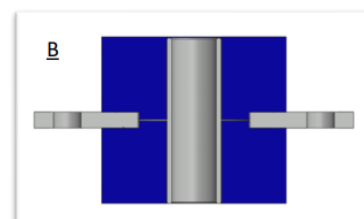
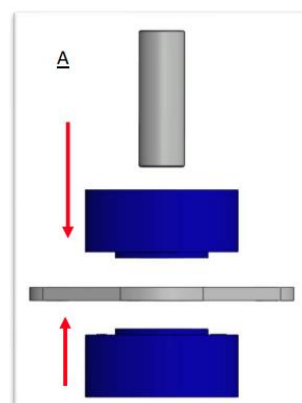

QUALITY PARTS AND ACCESSORIES



Triumph House, Sleaford Road, Bracebridge Heath, Lincoln LN4 2NA,
England Telephone: 01522 568000 | E-mail: sales@rimmerbros.com

www.rimmerbros.com

Registered in England No 1234567 | VAT No: 1234567